

LOCAL  
TRAFFIC  
ONLY

ONE LANE  
BRIDGE

PROPOSED ADVISORY SIGNS  
Sta.= 10+50 20 FT. Rt.

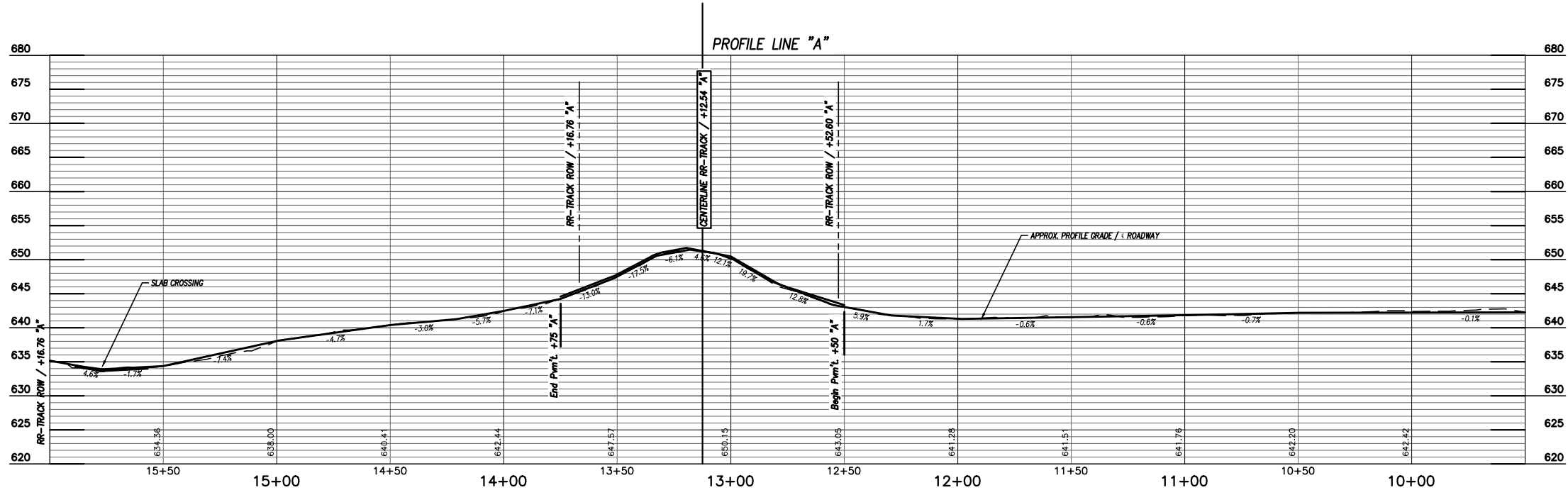
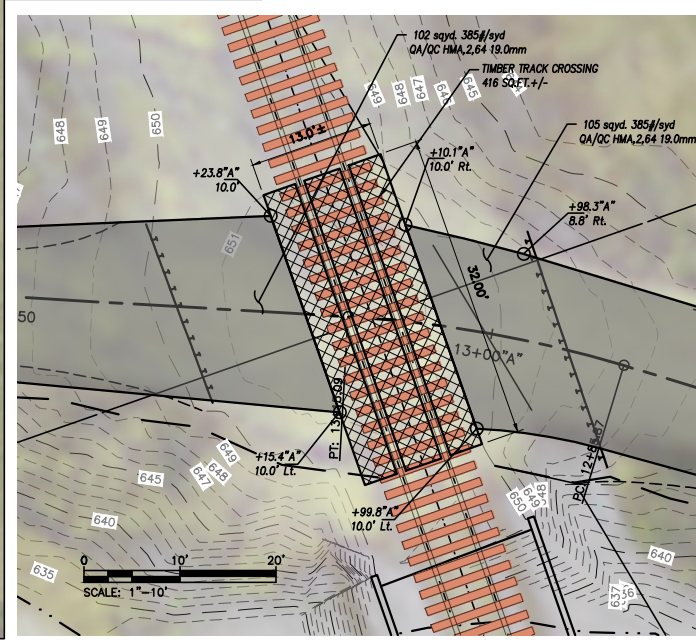

#### DISCLAIMER

- THIS EXHIBIT CREATED WITHOUT A BOUNDARY SURVEY AND/OR LIMITED FIELD TOPOGRAPHIC SURVEY. ALL INFORMATION SHOWN HEREIN IS BASED ON AVAILABLE PUBLIC INFORMATION SUCH AS THE BROWN COUNTY GIS SYSTEM, INDIANA UNIVERSITY ORTHO PHOTOGRAPHY AND INDIANA ATLAS LIDAR DATA. ANY AND ALL LOCATIONS, DIMENSIONS, ELEVATIONS OR OTHER PLAN INFORMATION HAVE BEEN DERIVED FROM SAID DATA AND INFORMATION.
- NO WARRANTY OR CERTIFICATION IS TO BE IMPLIED BY THE INFORMATION SHOWN OTHER THAN CONCEPTUAL AND/OR PURPOSES OF THIS INFORMATIVE EXHIBIT AS PRESENTED.

SCALE:  
1" = 30 FT. HORIZ.  
1" = 10 FT. VERT.



PROPOSED ADVISORY SIGNS  
Sta.= 5+50 20 FT. Rt.  
TO BE WITHIN/ON INDOT SR-45  
RIGHT-OF-WAY

PROPOSED RR CROSSING SIGNS  
Sta.= 12+90, 16.0 FT. Rt.  
Sta.= 13+13, 16.0 FT. Lt.

Figure 8B-2. Crossbuck Assembly with a YIELD or STOP Sign on the Crossbuck Sign Support

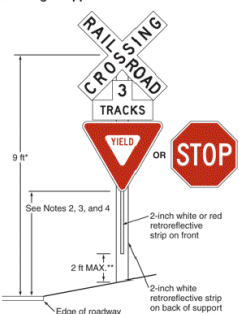

- Notes:
- YIELD or STOP signs are used only at passive crossings. A STOP sign is used only if an engineering study determines that it is appropriate for that particular approach.
  - Mounting height shall be at least 4 feet for installations of YIELD or STOP signs on existing Crossbuck sign supports.
  - Mounting height shall be at least 7 feet for new installations in areas with pedestrian movements or parking.

EXHIBIT "A"  
PETITION TO OPEN A HIGHWAY CROSSING AT GRADE  
INDIAN HILL ROAD; JACKSON TWP. BROWN COUNTY, INDIANA  
SECTIONS 28 & 33 of Twp. 10 NORTH; RANGE 2 EAST  
SUBMITTED: 5/22/2023

C.100